









HARD TREAD WHEELS

Cast Iron Tread Wheels

 Cast Iron (CA, CW, CH).....	133-134
 Single Flange (FL).....	135
 Double Flange (FD).....	135
 Cast Iron V-Groove (VG/VL).....	136
 Ductile V-Groove (VM).....	136
 Ductile Iron (Flat & Crowned) FM/FR.....	137





Steel Tread Wheels

 Drop Forged and Large Bore Forged (FS/FH).....	138
 Drop Forged V-Groove (VF/VH).....	139





Glass Filled Polypropylene Wheels

 Glass Filled Polypropylene (RT).....	140
--	-----



Nylon Tread Wheels

 Glass Filled Nylon (HT/DT).....	140
 Maxim® Glass-filled Nylon (NG).....	141
 White Nylon Wheels (NW).....	141
 Trionix™ High Impact Polymer (NX).....	142
 Trionix™ High Impact Polymer V-Groove (NV).....	142

Phenolic Wheels

 Straight Sided Phenolic (TH/TS).....	143
 Phenolic (TM).....	143-144
 Heat Resistant Phenolic (TR).....	144
 Laminated Phenolic (TL).....	144

Polypropylene Wheels

 Polypropylene (PB).....	145
 White Polypropylene (PW).....	145
 RETORT Polypropylene (RW).....	145

CA



Premium Quality



Heat Resistant

Cast Iron



Premium cast iron, sometimes referred to as semi-steel, offers the highest tensile strength in the industry (30,000 psi). CA wheels are a cost-effective solution for high capacity applications.

FEATURES

- **Wheel face:** Machined flat with rounded edges
- **Finish:** Gray enamel
- **Temperature Range:** Up to +800°F, consult factory for high temperature requirements
- **Hardness:** Brinell 145

WHEEL OPTIONS

- Note: Select bearings featured are recommended for standard applications. For special applications or alternate bearings consult factory. See bearing information on page 13
- For customization & special application options, please consult factory

Cast Iron Wheels (CA)										Wheel Number Tapered Roller (09)	Wheel Number Plain Bore (41)
Wheel Diameter (Inches)	Tread Width (Inches)	Capacity (Lbs) (Based on minimal operation)	Hub Length (Inches)	Bore ID (Inches)	Bearing ID (Inches)	Approx. Wt. (Lbs)	Wheel Number Roller Bearing (01, 05, 07)				
3	1-1/4	300	1-1/2	1/2	-	1-1/4				CA0304108	
3	1-5/16	300	1-3/8	1-1/16	1/2	1-1/4	CA0300108				
3-1/4	1-1/2	400	1-5/8	1-3/16	1/2	1	CA0310108				
3-1/4	1-1/2	400	1-5/8	1-3/16	5/8	1	CA0310110				
3-1/4	1-1/2^A	400	1-5/8	1-3/16	3/4	1	CA0310112~				
3-1/4	2	700	2-3/16	1-3/16	1/2	3-1/4	CA0320108				
3-1/4	2	700	2-3/16	1-3/16	5/8	3-1/4	CA0320110				
3-1/4	2	700	2-3/16	1-3/16	3/4	3-1/4	CA0320112~				
3-1/4	4	2000	4-1/2	1-15/16	3/4	6-1/2		CA0370912			
3-1/2	1-1/4	350	1-1/2	1/2	-	1				CA03X4108	
4	1-1/4	350	1-3/8	1/2	1/2	1-3/4				CA0404108	
4	1-5/16	350	1-3/8	1-1/16	1/2	1-3/4	CA0400108				
4	1-1/2	600	1-5/8	1-3/16	1/2	2-1/4	CA0410108				
4	1-1/2	600	1-5/8	1-3/16	5/8	2-1/4	CA0410110				
4	1-1/2^A	600	1-5/8	1-3/16	3/4	2-1/4	CA0410112~				
4	1-7/8	1000	2-3/16	1-7/16	1/2	3-1/4	CA0420108				
4	1-7/8	1000	2-3/16	1-7/16	5/8	3-1/4	CA0420110				
4	1-7/8	1000	2-3/16	1-3/16	3/4	3-1/4	CA0420112~				
4	3	2000	3-1/4	1-15/16	1	8-1/4	CA0450116				
4	3	2000	3-1/4	1-15/16	1-1/4	8-1/4	CA0450120				
4	4	4000	4-1/4	2-7/16	1-1/4	10-3/4	CA0470120*				
4	4	4000	4-1/4	2-7/16	1-1/2	10-3/4	CA0470124*				
5	1-1/4	350	1-1/2	1/2	-	2-1/4				CA0504108	
5	1-5/16	350	1-3/8	1-1/16	1/2	2-1/4	CA0500108				
5	1-1/2	600	1-5/8	1-3/16	1/2	3-1/4	CA0510108				
5	1-1/2	600	1-5/8	1-3/16	5/8	3-1/4	CA0510110				
5	1-1/2^A	600	1-5/8	1-3/16	3/4	3-1/4	CA0510112~				
5	1-7/8	1300	2-3/16	1-3/16	1/2	4-1/4	CA0520108				
5	1-7/8	1300	2-3/16	1-3/16	5/8	4-1/4	CA0520110				
5	1-7/8	1300	2-3/16	1-3/16	3/4	4-1/4	CA0520112~				
5	2-1/8	1500	2-3/16	1-7/16	7/8	5-1/4	CA0530114				
5	2-1/8	1500	2-3/16	1-7/16	1	5-1/4	CA0530116				
5	2-1/2	2300	3-1/4	1-15/16	1	10	CA0540116				
5	2-1/2	2300	3-1/4	1-15/16	1-1/4	10	CA0540120				
6	1-1/2	800	1-5/8	1-3/16	1/2	4	CA0610108				
6	1-1/2	800	1-5/8	1-3/16	5/8	4	CA0610110				
6	1-1/2^A	800	1-5/8	1-3/16	3/4	4	CA0610112~				
6	1-7/8	1400	2-3/16	1-3/16	1/2	6-1/4	CA0620108				
6	1-7/8	1400	2-3/16	1-3/16	5/8	6-1/4	CA0620110				
6	1-7/8	1400	2-3/16	1-3/16	3/4	6-1/4	CA0620112~				
6	2-1/2	2300	3-1/4	1-15/16	1	10-1/4	CA0640116				
6	2-1/2	2300	3-1/4	1-15/16	1-1/4	10-1/4	CA0640120				
6	2-1/2	1600	2-3/4	1-3/16	3/4	7-1/2	CA0640712				
6	2-1/2	1800	2-3/4	1-15/16	1	9-1/2	CA0640516				
6	2-1/2	2300	3-1/2	1-15/16	3/4	10		CA0640912			
6	3	2800	3-1/4	1-15/16	1	11-3/4	CA0650116				
6	3	2800	3-1/4	1-15/16	1-1/4	11-3/4	CA0650120				
6	3	2800	3-1/2	1-15/16	3/4	11-1/2		CA0650912			
8	2	1800	2-3/16	1-3/16	1/2	8-1/2	CA0820108				
8	2	1800	2-3/16	1-3/16	5/8	8-1/2	CA0820110				
8	2	1800	2-3/16	1-3/16	3/4	8-1/2	CA0820112~				
8	2-1/2	2300	3-1/4	1-15/16	1	13-1/4	CA0840116				
8	2-1/2	2300	3-1/4	1-15/16	1-1/4	13-1/4	CA0840120				
8	2-1/2	1600	2-3/4	1-3/16	3/4	10	CA0840712				
8	2-1/2	1800	2-3/4	1-15/16	1	13	CA0840516				
8	3	2800	3-1/4	1-15/16	1	11-3/4	CA0850116				
8	3	2800	3-1/4	1-15/16	1-1/4	11-3/4	CA0850120				
8	3	2800	3-1/2	1-15/16	3/4	11-1/2		CA0850912			
8	4	4000	4-1/4	2-7/16	1-1/4	27-1/4	CA0870120				
8	4	4000	4-1/4	2-7/16	1-1/2	27-1/4	CA0870124				
8	4	6000	4-1/2	2-7/16	1	26-1/2		CA0870916			
8	4	6000	4-1/2	2-7/16	1-1/4	26-1/2		CA0870920			
10	2-1/2	2300	3-1/4	1-15/16	1	17-1/2	CA1040116				
10	2-1/2	2300	2-3/4	1-15/16	1	17-1/2	CA1040516				
10	2-1/2	2300	3-1/4	1-15/16	1-1/4	17-1/2	CA1040120				

~ Nylon retainer thrust washers & hardened metal spanner bushing included.
 ^ 27/16" spanner and spacers included. * Crown face

Continue on next page >>

CAST IRON WHEELS • UP TO 8000



Continued from previous page

See previous page for CA description and product details.



Premium Quality



Heat Resistant



Large bore premium cast iron, sometimes referred to as semi-steel, offers the highest tensile strength in the industry (30,000 psi). CW wheels are a cost-effective solution for high capacity applications. See CA cast iron for features and options.



Premium Quality



Heat Resistant



Heavy duty premium cast iron, sometimes referred to as semi-steel, offers the highest tensile strength in the industry (30,000 psi). These wheels are a cost-effective solution for high capacity applications. See CA cast iron for features and options.

Wheel Diameter (Inches)	Tread Width (Inches)	Capacity (Lbs) (Based on manual operation)	Hub Length (Inches)	Bore ID (Inches)	Bearing ID (Inches)	Approx. Wt. (Lbs)	Wheel Number Roller Bearing (01, 05, 07)	Wheel Number Tapered Roller (09)	Wheel Number Plain Bore (41)
Cast Iron Wheels (CA)									
10	3	2800	3-1/4	1-15/16	1	16-3/4	CA1050116		
10	3	2800	3-1/4	1-15/16	1-1/4	16-3/4	CA1050120		
10	3	2800	3-1/2	1-15/16	3/4	16-1/2		CA1050912	
10	4	4000	4-1/4	2-7/16	1-1/4	33	CA1070120		
10	4	4000	4-1/4	2-7/16	1-1/2	33	CA1070124		
10	4	6000	4-1/2	2-7/16	1	32-1/2		CA1070916	
10	4	6000	4-1/2	2-7/16	1-1/4	32-1/2		CA1070920	
12	2-1/2	1800	2-3/4	1-15/16	1	20-1/2	CA1240516		
12	2-1/2	2300	3-1/4	1-15/16	1	20-1/2	CA1240116		
12	2-1/2	2300	3-1/4	1-15/16	1-1/4	20-1/2	CA1240120		
12	3	2800	3-1/4	1-15/16	1	22	CA1250116		
12	3	2800	3-1/4	1-15/16	1-1/4	22	CA1250120		
12	3	2800	3-1/2	1-15/16	3/4	21-3/4		CA1250912	
12	3-1/2	4000	4-1/4	2-7/16	1-1/4	35-1/2	CA1260120		
12	3-1/2	4000	4-1/4	2-7/16	1-1/2	35-1/2	CA1260124		
12	3-1/2	4000	4-1/2	2-7/16	1	35		CA1260916	
12	3-1/2	4000	4-1/2	2-7/16	1-1/4	35		CA1260920	
14	4	4000	4-1/4	2-7/16	1-1/4	49-1/2	CA1470120		
14	4	4000	4-1/4	2-7/16	1-1/2	49-1/2	CA1470124		
16	3	4000	4-1/4	2-7/16	1-1/4	52-1/4	CA1650120		
16	3	4000	4-1/4	2-7/16	1-1/2	52-1/4	CA1650124		
16	4	5000	5-1/4	2-7/16	1-1/4	65-1/4	CA1670120		
16	4	5000	5-1/4	2-7/16	1-1/2	65-1/4	CA1670124		
18	3	4000	4-1/4	2-7/16	1-1/4	58	CA1850120		
18	3	4000	4-1/4	2-7/16	2	58	CA1850124		

Wheel Diameter (Inches)	Tread Width (Inches)	Capacity (Lbs) (Based on manual operation)	Hub Length (Inches)	Bore ID (Inches)	Bearing ID (Inches)	Approx. Wt. (Lbs)	Wheel Number Roller Bearing (01)	Wheel Number Bronze Bearing (22)*	Wheel Number Annular Ball Bearing (31)
Large Bore Premium Cast Iron Wheels (CW)									
8	3	6000	3-1/4	2-7/16	1-1/4	21-3/4	CW0850120		
8	3	6000	3-1/4	2-7/16	1-1/2	21-3/4	CW0850124		
8	3	8000	3-1/2	2-7/16	1	21-1/2		CW0850916	
8	3	8000	3-1/2	2-7/16	1-1/4	21-1/2		CW0850920	

Wheel Diameter (Inches)	Tread Width (Inches)	Capacity (Lbs) (Based on manual operation)	Hub Length (Inches)	Bore ID (Inches)	Bearing ID (Inches)	Approx. Wt. (Lbs)	Wheel Number Roller Bearing (01)	Wheel Number Bronze Bearing (22)*	Wheel Number Annular Ball Bearing (31)
Heavy Duty Cast Iron Wheels (CH)									
5	2	1500	2-3/16	1-3/16	1/2	4-1/4	CH0520108		CH0523108
5	2	1500	2-3/16	1-3/16	5/8	4-1/4	CH0520110		
5	2	1500	2-3/16	1-3/16	3/4	4-1/4	CH0520112~	CH0522212	
6	2	1700	2-3/16	1-3/16	1/2	6-1/4	CH0620108		CH0623108
6	2	1700	2-3/16	1-3/16	5/8	6-1/4	CH0620110		
6	2	1700	2-3/16	1-3/16	3/4	6-1/4	CH0620112~	CH0622212	
8	2	1800	2-3/16	1-3/16	1/2	8-1/2	CH0820108		CH0823108
8	2	1800	2-3/16	1-3/16	5/8	8-1/2	CH0820110		
8	2	1800	2-3/16	1-3/16	3/4	8-1/2	CH0820112~	CH0822112	

~ Nylon retainer thrust washers & hardened metal spanner bushing included.
* Hub length increases to 2-3/8" on bronze bearings.

FL Single Flange

Premium Quality

Heat Resistant

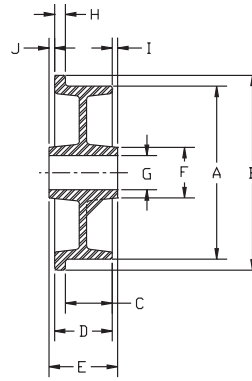

Letters match to chart descriptions below.

Various bore sizes are available for FL for use as plain bore wheels or to be used with keyway and set screw or with a variety of bearings. This cast iron wheel offers 30,000 psi tensile strength.

FEATURES

- **Finish:** Gray enamel
- **Temperature Range:** Up to +800°F, consult factory for high temperature requirements
- **Hardness:** Brinell 145

WHEEL OPTIONS

- Note: Select bearings featured are recommended for standard applications. For special applications or alternate bearings consult factory. See bearing information on page 13
- For customization & special application options, please consult factory

Face Diameter "A" (Inches)	Flange OD "B" (Inches)	Face Width "C" (Inches)	O.A. Width "D" (Inches)	Hub Length "E" (Inches)	Hub O.D. "F" (Inches)	Bore "G" (Inches)	Flange Width "H" (Inches)	Hub Offset "I" (Inches)	Hub Offset "J" (Inches)	Capacity (Lbs)	Bearing Size (Inches)	Approx. Wt. (Lbs)	Wheel Number Straight Roller (01)	Wheel Number Tapered Roller (09)
Single Flange (FL)														
3	4	1	1-3/8	2-3/16	1-5/8	1-3/16	3/8	9/16	1/4	700	3/4	3	FL0320112	
3-1/4	4	1	1-3/8	2-3/16	1-3/4	1-3/16	3/8	19/32	7/32	700	3/4	3	FL0310112	
4-1/2	5-1/2	1-9/16	2-3/8	2-1/2	2-1/2	1-15/16	13/16	1/16	1/16	1500	1	9-1/2	FL0410116	
4-1/2	5-1/2	1-9/16	2-3/8	2-1/2	2-1/2	1-15/16	13/16	1/16	1/16	1500	3/4	9-1/2		FL0410912
5	6	1-1/8	1-1/2	2-3/16	1-3/4	1-3/16	3/8	11/32	11/32	500	3/4	5-1/4	FL0510112	
5-3/8	6-1/8	1-5/16	1-11/16	2-3/16	1-3/4	1-3/16	3/8	13/32	3/32	900	3/4	5	FL0520112	
5	6	1-1/8	1-15/16	3-1/4	2-1/2	1-15/16	13/16	15/16	3/8	1000	1	6-1/2	FL0520116	
5	6	1-1/8	1-15/16	3-1/2	2-1/2	1-15/16	13/16	15/16	3/8	1000	3/4	6-1/2		FL0520912
6	6-3/4	1-5/8	2	2-3/16	1-3/4	1-3/16	3/8	3/32	3/32	900	3/4	8-1/2	FL0620112	
7-1/16	8-3/4	1-3/4	2-3/16	2-3/4	2-5/8	1-15/16	7/16	9/32	9/32	1200	1	12-3/4	FL0720116	
7-1/16	8-3/4	1-3/4	2-3/16	3	2-5/8	1-15/16	7/16	9/32	9/32	1200	3/4	12-3/4		FL0720912
8	9-1/2	2	2-1/2	3-1/4	3	1-15/16	1/2	3/8	3/8	1600	1	16-1/4	FL0840116	
8	9-1/2	2	2-1/2	3-1/2	3	1-15/16	1/2	3/8	3/8	1600	3/4	16-1/4		FL0840912
10	12	2-3/8	3	3-1/4	3	1-15/16	5/8	1/8	1/8	2000	1	29-1/4	FL1050116	
10	12	2-3/8	3	3-1/2	3	1-15/16	5/8	1/8	1/8	2000	3/4	29-1/4		FL1050912
14	16	3	3-5/8	4-1/4	4-1/4	2-7/16	5/8	5/16	5/16	3000	1-1/4	56	FL1460120	
14	16	3	3-5/8	4-1/2	4-1/4	2-7/16	5/8	5/16	5/16	3000	1	56		FL1460916

FD Double Flange

Premium Quality

Heat Resistant



Face Diameter "A" (Inches)	Flange OD "B" (Inches)	Face Width "C" (Inches)	O.A. Width "D" (Inches)	Hub Length "E" (Inches)	Hub O.D. "F" (Inches)	Bore "G" (Inches)	Flange Width "H" (Inches)	Hub Offset "I" (Inches)	Hub Offset "J" (Inches)	Capacity (Lbs)	Bearing Size (Inches)	Approx. Wt. (Lbs)	Wheel Number Straight Roller (01)	Wheel Number Tapered Roller (09)
Double Flange (FD)														
5	6	3/4	1-1/2	2-3/16	1-3/4	1-3/16	3/8	11/32	11/32	500	3/4	6	FD0510112	
10	12	1-3/4	3	3-1/4	3	1-15/16	5/8	1/8	1/8	2000	1	35	FD1050116	
10	12	1-3/4	3	3-1/2	3	1-15/16	5/8	1/8	1/8	2000	3/4	35		FD1050912

FD offers various bore sizes for use as plain bore wheels or to be used with keyway and set screw or with a variety of bearings. This cast iron wheel offers 30,000 psi tensile strength. See FL for features and options.

VG/VL

 Premium Quality  Heat Resistant
Cast Iron V-Groove

Letters match to chart descriptions

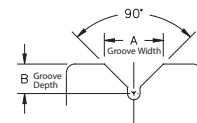

Wheel face and "V"-groove are machined from heavy duty cast iron. A relief groove at the base of the "V" tends to equalize the load to each face of the angle track when in operation. Wheel face and bore are machined for concentricity to proper tracking. These wheels can be used not only on track but flat surfaces as well. VL wheels feature a larger bore for greater capacity.

Please note: Track alignment is critical when utilizing v-groove wheels.

FEATURES

- **Wheel face:** V-Groove
- **Finish:** Silver Enamel Paint
- **Temperature Range:** Up to +350°F, consult factory for high temperature requirements
- **Hardness:** Brinell 145 **Tensile:** 30,000 psi

WHEEL OPTIONS

- Note: Select bearings featured are recommended for standard applications. For special applications or alternate bearings consult factory. See bearing information on page 13
- For customization & special application options, please consult factory



VM

Ductile V-Groove

Albion VM Ductile Wheels feature higher capacities compared to cast iron V-Groove wheels. Wheels are painted black.

Letters match to chart descriptions

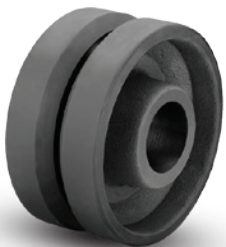
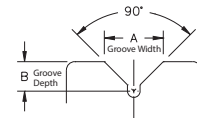

FEATURES

- **Wheel face:** V-Groove
- **Finish:** Flat Black Paint w/Rust Inhibitor
- **Temperature Range:** Up to +350°F, consult factory for high temperature requirements
- **Hardness:** Brinell 131 – 217 (mechanical properties ASTM A536 grade 65-45-12)
- **Tensile:** 65,000 psi

WHEEL OPTIONS

- Note: Select bearings featured are recommended for standard applications. For special applications or alternate bearings consult factory. See bearing information on page 13.
- For customization & special application options, please consult factory

Wheel Diameter (Inches)	Tread Width (Inches)	Capacity (Lbs) (Rated for manual operation)	Hub Length (Inches)	Bore ID (Inches)	Bearing ID (Inches)	Groove Width "A" (Inches)	Groove Depth "B" (Inches)	Approx. Wt. (Lbs)	Wheel Number Roller Bearing (O1)	Wheel Number Tapered Roller (O9)
4	2	800	2-3/16	1-3/16	5/8	7/8	7/16	4	VG0420110	
4	2	800	2-3/16	1-3/16	3/4	7/8	7/16	4	VG0420112~	
5	2	800	2-3/16	1-3/16	5/8	7/8	7/16	5	VG0520110	
5	2	800	2-3/16	1-3/16	3/4	7/8	7/16	5	VG0520112~	
6	2	1000	2-3/16	1-3/16	5/8	7/8	7/16	8	VG0620110	
6	2	1000	2-3/16	1-3/16	3/4	7/8	7/16	8	VG0620112~	
6	2-1/2	2500	3-1/4	1-15/16	1	7/8	7/16	11-3/4	VG0640116	
6	2-1/2	2500	3-1/4	1-15/16	1-1/4	7/8	7/16	11-3/4	VG0640120	
6	2-1/2	2500	3-1/2	1-15/16	3/4	7/8	7/16	11-1/2		VG0640912
8	2-1/2	2500	3-1/4	1-15/16	1	7/8	7/16	15-1/2	VG0840116	
8	2-1/2	2500	3-1/4	1-15/16	1-1/4	7/8	7/16	15-1/2	VG0840120	
8	2-1/2	2500	3-1/2	1-15/16	3/4	7/8	7/16	15-1/2		VG0840912
8	2-1/2	2500	3-1/2	2	1	7/8	7/16	15-1/2		VG0840916
8	3	2500	3-1/4	1-15/16	1	7/8	7/16	16-3/4	VG0850116	
8	3	2500	3-1/4	1-15/16	1-1/4	7/8	7/16	16-3/4	VG0850120	
8	3	2500	3-1/2	1-15/16	3/4	7/8	7/16	16-1/2		VG0850912
8	3	2500	3-1/2	2	1	7/8	7/16	16-1/2		VG0850916
8	3	4000	3-1/4	2-7/16	1-1/4	1-3/8	11/16	17-3/4	VL0850120	
8	3	4000	3-1/4	2-7/16	1-1/2	1-3/8	11/16	17-3/4	VL0850124	
8	3	4000	3-1/2	2-7/16	1	1-3/8	11/16	17-1/4		VL0850916
8	3	4000	3-1/2	2-7/16	1-1/4	1-3/8	11/16	17-1/4		VL0850920
10	3	3000	3-1/4	1-15/16	1	1-3/8	11/16	27	VG1050116	
10	3	3000	3-1/4	1-15/16	1-1/4	1-3/8	11/16	27	VG1050120	
10	3	3500	3-1/2	1-15/16	3/4	1-3/8	11/16	26-3/4		VG1050912
10	3	3500	3-1/2	2	1	1-3/8	11/16	26-3/4		VG1050916
10	3	4000	3-1/4	2-7/16	1-1/4	1-3/8	11/16	28	VL1050120	
10	3	4000	3-1/4	2-7/16	1-1/2	1-3/8	11/16	28	VL1050124	
10	3	4000	3-1/2	2-7/16	1	1-3/8	11/16	27-1/4		VL1050916
10	3	4000	3-1/2	2-11/32	1-1/4	1-3/8	11/16	27-1/4		VL1050920

~ Wheels are complete with spanner bushing and nylon sealed retaining/thrust washer.

Wheel Diameter (Inches)	Tread Width (Inches)	Capacity (Lbs) (Rated for manual operation)	Hub Length (Inches)	Bore ID (Inches)	Bearing ID (Inches)	Groove Width "A" (Inches)	Groove Depth "B" (Inches)	Approx. Wt. (Lbs)	Wheel Number Roller Bearing (O1)	Wheel Number Tapered Roller (O9)
6	2-1/2	3500	3-1/4	1-15/16	1	7/8	7/16	9-1/2	VM0640116	
6	2-1/2	3500	3-1/4	1-15/16	1-1/4	7/8	7/16	9-1/2	VM0640120	
6	2-1/2	3500	3-1/2	1-15/16	3/4	7/8	7/16	9-1/2		VM0640912
6	3	5000	3-1/4	1-15/16	1	7/8	7/16	10-1/2	VM0650116	
6	3	5000	3-1/4	1-15/16	1-1/4	7/8	7/16	10-1/2	VM0650120	
6	3	5000	3-1/2	1-15/16	3/4	7/8	7/16	10-1/2		VM0650912
8	3	5000	3-1/4	1-15/16	1	7/8	7/16	16-1/2	VM0850116	
8	3	5000	3-1/4	1-15/16	1-1/4	7/8	7/16	16-1/2	VM0850120	
8	3	5000	3-1/2	1-15/16	3/4	7/8	7/16	16-1/2		VM0850912
8	3	5000	3-1/2	1-15/16	1	7/8	7/16	16-1/2		VM0850916
10	3	6000	3-1/4	1-15/16	1	1-3/8	11/16	26	VM1050116	
10	3	6000	3-1/4	1-15/16	1-1/4	1-3/8	11/16	26	VM1050120	
10	3	6000	3-1/2	1-15/16	3/4	1-3/8	11/16	26		VM1050912
10	3	6000	3-1/2	1-15/16	1	1-3/8	11/16	26		VM1050916

4x2 and 6x2 models coming soon – consult factory.

FM



Premium Quality



Heat Resistant

Flat Tread Ductile



Albion FM Ductile Wheels feature higher capacities compared to cast iron wheels. Wheels are painted black.

FEATURES

- **Wheel face:** Flat tread design
- **Finish:** Black paint
- **Temperature Range:** Up to +800°F, consult factory for high temperature requirements
- **Tensile Strength:** 65K PSI

WHEEL OPTIONS

- Note: Select bearings featured are recommended for standard applications. For special applications or alternate bearings consult factory. See bearing information on page 13
- For customization & special application options, please consult factory

Wheel Diameter (Inches)	Tread Width (Inches)	Capacity (Lbs) (Based for manual operation)	Hub Length (Inches)	Bore ID (Inches)	Bearing ID (Inches)	Approx. Wt. (LBS)	Wheel Number Plain Bore (00)	Wheel Number Roller Bearing (01)	Wheel Number Tapered Roller (09)
Flat Tread Ductile Flat Tread Painted Black (FM)									
5	2	1500	2-3/16	1-3/16	3/4	6	FM0520019	FM0520112	
5	2	1500	2-7/16	1-3/8	1/2	6			FM0520908
6	2	1500	2-3/16	1-3/16	3/4	7-1/2	FM0620019	FM0620112	
6	2	2000	2-7/16	1-3/8	1/2	7-1/2			FM0620908
6	2-1/2	3500	3-1/4	1-15/16	1-1/4	10-1/2	FM0640031	FM0640120	
6	2-1/2	3500	3-1/2	1-15/16	3/4	10-1/2			FM0640912
6	3	6000	3-1/4	1-15/16	1-1/4	11-1/2	FM0650031	FM0650120	
6	3	6000	3-1/2	1-15/16	3/4	11-1/2			FM0650912
8	2	2000	2-3/16	1-3/16	3/4	11	FM0820019	FM0820112	
8	2	2000	2-7/16	1-3/8	1/2	11			FM0820908
8	3	6000	3-1/4	1-15/16	1	15-1/2	FM0850031	FM0850116	
8	3	6000	3-1/2	1-15/16	3/4	15-1/2			FM0850912
10	3	6000	3-1/4	1-15/16	1-1/4	20-1/2	FM1050031	FM1050120	
10	3	6000	3-1/2	1-15/16	3/4	20-1/2			FM1050912

Wheel Diameter (Inches)	Tread Width (Inches)	Capacity (Lbs) (Based for manual operation)	Hub Length (Inches)	Bore ID (Inches)	Bearing ID (Inches)	Approx. Wt. (LBS)	Wheel Number Plain Bore (00)	Wheel Number Roller Bearing (01)	Wheel Number Tapered Roller (09)
Flat Tread Ductile Flat Tread Unpainted (FM)									
12	3-1/2	6000	4-1/4	2-7/16	1-1/4	40-1/2		FM1260120	
12	3-1/2	6000	4-1/4	2-7/16	1-1/2	40-1/2		FM1260124	
12	3-1/2	6000	4-1/2	2-7/16	1	40			FM1260916
12	3-1/2	6000	4-1/2	2-7/16	1-1/4	40			FM1260920

3-1/2" tread width models are not painted.

FR



Premium Quality



Heat Resistant

Full Radius Ductile Tread



FR Full Radius Ductile Tread Design For Easier Maneuverability

Albion FR Ductile Wheels feature higher capacities compared to cast iron wheels. Full radius tread design makes them easier to swivel and roll. Wheels are painted black.

FEATURES

- **Wheel face:** Full radius tread design
- **Finish:** Black paint
- **Temperature Range:** Up to +800°F, consult factory for high temperature requirements
- **Tensile Strength:** 65K PSI

WHEEL OPTIONS

- Note: Select bearings featured are recommended for standard applications. For special applications or alternate bearings consult factory. See bearing information on page 13
- For customization & special application options, please consult factory

Wheel Diameter (Inches)	Tread Width (Inches)	Capacity (Lbs) (Based for manual operation)	Hub Length (Inches)	Bore ID (Inches)	Bearing ID (Inches)	Approx. Wt. (LBS)	Wheel Number Plain Bore (00)	Wheel Number Roller Bearing (01)	Wheel Number Tapered Roller (09)
Full Radius Tread Ductile (FR)									
5	2	1500	2-3/16	1-3/16	3/4	6	FR0520019	FR0520112	
5	2	1500	2-7/16	1-3/8	1/2	6			FR0520908
6	2	2000	2-3/16	1-3/16	3/4	7-1/2	FR0620019	FR0620112	
6	2	2000	2-7/16	1-3/8	1/2	7-1/2			FR0620908
6	2-1/2	3500	3-1/4	1-15/16	1-1/4	10-1/2	FR0640031	FR0640120	
6	2-1/2	3500	3-1/2	1-15/16	3/4	10-1/2			FR0640912
6	3	6000	3-1/4	1-15/16	1-1/4	11-1/2	FR0650031	FR0650120	
6	3	6000	3-1/2	1-15/16	3/4	11-1/2			FR0650912
8	2	1500	2-3/16	1-3/16	3/4	11	FR0820019	FR0820112	
8	2	2000	2-7/16	1-3/8	1/2	11			FR0820908
8	3	6000	3-1/4	1-15/16	1-1/4	15-1/2	FR0850031	FR0850120	
8	3	6000	3-1/2	1-15/16	3/4	15-1/2			FR0850912
10	3	6000	3-1/4	1-15/16	1-1/4	20-1/2	FR1050031	FR1050120	
10	3	6000	3-1/2	1-15/16	3/4	20-1/2			FR1050912

CAST IRON WHEELS • UP TO 6000

FS

 Premium Quality

 Heat Resistant

Drop Forged Steel



Drop forged steel wheels are hot forged from carbon steel billets. The forging process improves grain flow, enhances ductility and tensile strength. Suitable for high capacity, abusive applications. Forged steel is 64,000 psi tensile strength.

FEATURES

- **Wheel face:** Machined flat with rounded edges
- **Finish:** Clear coat enamel
- **Temperature Range:** Up to +800°F, consult factory for high temperature requirements
- **Hardness:** Rockwell 80 B

WHEEL OPTIONS

- Note: Select bearings featured are recommended for standard applications. For special applications or alternate bearings consult factory. See bearing information on page 13
- For customization & special application options, please consult factory

Wheel Diameter (Inches)	Tread Width (Inches)	Capacity (Lbs) (Rated for normal operation)	Hub Length (Inches)	Bore ID (Inches)	Bearing ID (Inches)	Approx. Wt. (Lbs)	Wheel Number Roller Bearing (01)	Wheel Number Tapered Roller (08, 09)
Drop Forged Steel Wheels (FS)								
4	1-1/2	1400	2-3/16	1-3/16	1/2	3-1/4	FS0410108	
4	1-1/2	1400	2-3/16	1-3/16	5/8	3-1/4	FS0410110	
4	1-1/2	1400	2-3/16	1-3/16	3/4	3-1/4	FS0410112~	
4	1-1/2	1400	2-7/16	1-3/8	1/2	3-1/4		FS0410908
5	1-3/4	1500	2-3/16	1-3/16	1/2	5-1/4	FS0520108	
5	1-3/4	1500	2-3/16	1-3/16	5/8	5-1/4	FS0520110	
5	1-3/4	1500	2-3/16	1-3/16	3/4	5-1/4	FS0520112~	
5	1-3/4	1800	2-7/16	1-3/8	1/2	5-1/4		FS0520908
6	2	1700	2-3/16	1-3/16	1/2	6-1/4	FS0620108	
6	2	1700	2-3/16	1-3/16	5/8	6-1/4	FS0620110	
6	2	1700	2-3/16	1-3/16	3/4	6-1/4	FS0620112~	
6	2	2500	2-7/16	1-3/8	1/2	6-1/4		FS0620908
6	2	2500	2-7/16	1-7/8	3/4	6-1/4		FS0620912
6	2-1/2	4000	3-1/4	1-15/16	1	11-3/4	FS0640116	
6	2-1/2	4000	3-1/4	1-15/16	1-1/4	11-3/4	FS0640120	
6	2-1/2	5000	3-1/2	1-7/8	3/4	11-1/4		FS0640912
6	2-1/2	5000	3-1/2	2-1/4	1	11-3/4		FS0640916
6	3	6000	3-1/4	2-7/16	1-1/4	20-1/4	FS0650120	
6	3	6000	3-1/2	2-7/16	1-1/2	20-1/4	FS0650124	
6	3	10000	3-1/2	2-7/16	1	19-3/4		FS0650916
6	3	10000	3-1/2	2-7/16	1-1/8	19-3/4		FS0650918
6	3	10000	3-1/2	2-7/16	1-1/4	19-3/4		FS0650920
8	2-1/2	4000	3-1/4	1-15/16	1	18	FS0840116	
8	2-1/2	4000	3-1/4	1-15/16	1-1/4	18	FS0840120	
8	3	4500	3-1/4	1-15/16	1	18-1/4	FS0850116	
8	3	4500	3-1/4	1-15/16	1-1/4	18-1/4	FS0850120	
8	3	5500	3-1/2	1-15/16	3/4	18-1/4		FS0850912
8	3	5500	3-1/2	2-1/4	1	18-1/4		FS0850916
8	4	8350	4-1/4	2-7/16	1-1/4	35-1/2	FS0870120	
8	4	8350	4-1/4	2-7/16	1-1/2	35-1/2	FS0870124	
8	4	10000	4-1/2	2-7/16	1	36-1/2		FS0870916
8	4	10000	4-1/2	2-7/16	1-1/8	36-1/2		FS0870918
8	4	10000	4-1/2	2-7/16	1-1/4	36-1/2		FS0870920
10	3	5000	3-1/4	1-15/16	1	27-3/4	FS1050116	
10	3	5000	3-1/4	1-15/16	1-1/4	27-3/4	FS1050120	
10	3	6000	3-1/2	1-15/16	3/4	27-1/2		FS1050912
10	4	8350	4-1/4	2-7/16	1-1/4	48	FS1070120	
10	4	8350	4-1/4	2-7/16	1-1/2	48	FS1070124	
10	4	10000	4-1/2	2-7/16	1	47-1/4		FS1070916
10	4	10000	4-1/2	2-7/16	1-1/8	47-1/4		FS1070918
10	4	10000	4-1/2	2-7/16	1-1/4	47-1/4		FS1070920

~ Wheels are complete with spanner bushing and nylon sealed retaining/thrust washer.

FH

 Premium Quality

 Heat Resistant

Large Bore Drop Forged Steel



These dropped forged steel wheels are a large bore version of FS wheels. See FS wheels for features and options.

Up to 20,000 lbs Capacity!

Wheel Diameter (Inches)	Tread Width (Inches)	Capacity (Lbs) (Rated for normal operation)	Hub Length (Inches)	Bore ID (Inches)	Bearing ID (Inches)	Approx. Wt. (Lbs)	Wheel Number Roller Bearing (01)	Wheel Number Tapered Roller (09)
Large Bore Drop Forged Steel Wheels (FH)								
6	3	17000	3-1/2	3-1/8	1-1/4	22-1/4		FH0650920
6	3	17000	3-1/2	3-1/8	1-1/2	22-1/4		FH0650924
8	3	6500	3-1/4	2-7/16	1-1/4	34	FH0850120	
8	4	20000	4-1/2	3-1/8	1-1/4	34		FH0870920
8	4	20000	4-1/2	3-1/8	1-1/2	34		FH0870924
10	3	6000	3-1/4	2-7/16	1-1/4	37-1/4	FH1050120	
10	3	6000	3-1/4	2-7/16	1-1/2	37-1/4	FH1050124	
10	3	6500	3-1/2	2-7/16	1	37		FH1050916
10	3	6500	3-1/2	2-7/16	1-1/4	37		FH1050920
10	4	20000	4-1/2	3-1/8	1-1/4	46-1/4		FH1070920
10	4	20000	4-1/2	3-1/8	1-1/2	46-1/4		FH1070924

VF/VH



Premium Quality



Heat Resistant

Drop Forged Steel V-Groove

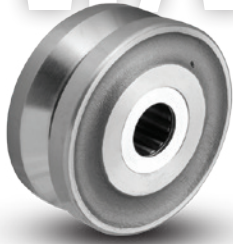

Wheel face and "V"-groove are machined from drop forged steel. A relief groove at the base of the "V" tends to equalize the load to each face of the angle track when in operation. Wheel face and bore are machined for concentricity to proper tracking. These wheels can be used not only on a track but flat surfaces as well. VH wheels feature a larger bore for greater capacity.

Please note: Track alignment is critical when utilizing v-groove wheels.

FEATURES

- **Wheel face:** V-Groove
- **Finish:** Clear Coat Enamel w/Rust Inhibitor
- **Temperature Range:** Up to +350°F, consult factory for high temperature requirements
- **Hardness:** Brinell 149 (converted from Rockwell 80 B)
- **Tensile:** 64,000 psi

WHEEL OPTIONS

- Note: Select bearings featured are recommended for standard applications. For special applications or alternate bearings consult factory. See bearing information on page 13
- For customization & special application options, please consult factory

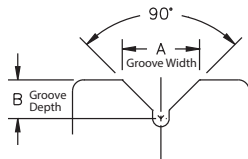

Letters match to chart descriptions

Wheel Diameter (Inches)	Tread Width (Inches)	Capacity (Lbs) (rated for manual operation)	Hub Length (Inches)	Bore ID (Inches)	Bearing ID (Inches)	Groove Width "A" (Inches)	Groove Depth "B" (Inches)	Approx. Wt. (Lbs)	Wheel Number Roller Bearing (01)	Wheel Number Tapered Roller (09)
Drop Forged Steel V-Groove (VF, VH)										
6	3	6000	3-1/4	2-7/16	1-1/4	1-3/8	11/16	20-1/4	VF0650120	
6	3	6000	3-1/4	2-7/16	1-1/2	1-3/8	11/16	20-1/4	VF0650124	
6	3	10000	3-1/2	2-7/16	1	1-3/8	11/16	19-3/4		VF0650916
6	3	10000	3-1/2	2-7/16	1-1/4	1-3/8	11/16	19-3/4		VF0650920
6	3	15000	3-1/2	3-1/8	1-1/4	1-3/8	11/16	22		VH0650920
6	3	15000	3-1/2	3-1/8	1-1/2	1-3/8	11/16	22		VH0650924
8	3	6000	3-1/4	1-15/16	1	7/8	7/16	30	VF0850116	
8	4	8350	4-1/4	2-7/16	1-1/4	1-3/4	7/8	21-3/4	VF0870120	
8	4	8350	4-1/4	2-7/16	1-1/2	1-3/4	7/8	21-3/4	VF0870124	
8	4	10000	4-1/2	2-7/16	1	1-3/4	7/8	21		VF0870916
8	4	10000	4-1/2	2-7/16	1-1/4	1-3/4	7/8	21		VF0870920
8	4	15000	4-1/2	3-1/8	1-1/4	1-3/4	7/8	27-1/2		VH0870920
8	4	15000	4-1/2	3-1/8	1-1/2	1-3/4	7/8	27-1/2		VH0870924
10	3	6000	3-1/4	2-7/16	1-1/4	1-3/8	11/16	37-1/2	VH1050120	
10	3	6000	3-1/4	2-7/16	1-1/2	1-3/8	11/16	37-1/2	VH1050124	
10	3	6000	3-1/2	2-7/16	1	1-3/8	11/16	37		VH1050916
10	3	6000	3-1/2	2-7/16	1-1/4	1-3/8	11/16	37		VH1050920
10	3	5000	3-1/4	1-15/16	1	1-3/8	11/16	27-3/4	VF1050116	
10	3	5000	3-1/4	1-15/16	1-1/4	1-3/8	11/16	27-3/4	VF1050120	
10	4	8350	4-1/4	2-7/16	1-1/4	1-3/4	7/8	48	VF1070120	
10	4	8350	4-1/4	2-7/16	1-1/2	1-3/4	7/8	48	VF1070124	
10	4	10000	4-1/2	2-7/16	1	1-3/4	7/8	47-1/4		VF1070916
10	4	10000	4-1/2	2-7/16	1-1/4	1-3/4	7/8	47-1/4		VF1070920
10	4	15000	4-1/2	3-1/8	1-1/4	1-3/4	7/8	46-1/4		VH1070920
10	4	15000	4-1/2	3-1/8	1-1/2	1-3/4	7/8	46-1/4		VH1070924

FORGED STEEL WHEELS • UP TO 15000



Economical

RT Glass Filled Polypropylene



Premium Quality



Heat Resistant

HT High Heat Glass Filled Nylon



Premium Quality



Heat Resistant

DT Heavy Duty Glass Filled Nylon



Need tough, heat resistant wheels? Albion offers three versions: the RT, HT, and the newest addition to the family, the DT. These wheels are ideal for food processing, tool storage, sanitary maintenance, and applications requiring easy mobility under heavy loads. All three are extremely resistant to water, chemical absorption, steam cleaning, and HEAT!

FEATURES

- **Wheel face:** Moderate crown
- **Finish:** RT & HT (Black) DT (Dark Grey)
- **Material:**

RT: Glass filled polypropylene

HT: Glass filled nylon designed for higher temperature applications

DT: Heavy duty version of the RT wheels with regards to impact and load capacity and are made from a glass filled nylon with impact modifiers and temperature stabilization formulation

- **Temperature Range:**

RT: -20°F to +250°F

HT: -20°F to +480°F

DT: -20°F to +350°F

- **Hardness:**

RT: 65-70 Shore D

HT: 75-80 Shore D

DT: 75-80 Shore D

Glass Filled Polypropylene (RT)							Wheel Number Roller Bearing (01)	Wheel Number Precision Ball Bearing (28)	Wheel Number Pedestal Precision Ball Bearing (29)
Wheel Diameter (Inches)	Tread Width (Inches)	Capacity (Lbs) (Rated for manual operation)	Hub Length (Inches)	Bore ID (Inches)	Bearing ID (Inches)				
4	2	800	2-3/16	1-3/16	3/4	RT0420112			
4	2	800	2-3/16	1-3/16	1/2		RT0422808*	RT0422908	
5	2	1000	2-3/16	1-3/16	3/4	RT0520112			
5	2	1000	2-3/16	1-3/16	1/2		RT0522808*	RT0522908	
6	2	1200	2-3/16	1-3/16	3/4	RT0620112			
6	2	1200	2-3/16	1-3/16	1/2		RT0622808*	RT0622908	
8	2	1400	2-3/16	1-3/16	3/4	RT0820112~			
8	2	1400	2-3/16	1-3/16	3/4		RT0822808*	RT0822908	

*Requires (2) top hats to achieve 1/2" ID; order (2) of part number 41774 for each wheel ordered.

High Heat Glass Filled Nylon (HT)								
Wheel Diameter (Inches)	Tread Width (Inches)	Capacity (Lbs) (Rated for manual operation)	Hub Length (Inches)	Bore ID (Inches)	Bearing ID (Inches)			
4	2	800	2-3/16	1-3/16	3/4	HT0420112		
5	2	1000	2-3/16	1-3/16	3/4	HT0520112		
6	2	1200	2-3/16	1-3/16	3/4	HT0620112		
8	2	1400	2-3/16	1-3/16	3/4	HT0820112		

High temp Delrin bearing available, consult factory.

Heavy Duty Glass Filled Nylon (DT)									
Wheel Diameter (Inches)	Tread Width (Inches)	Capacity (Lbs) (Rated for manual operation)	Hub Length (Inches)	Bore ID (Inches)	Bearing ID (Inches)				
4	2	1000	2-3/16	1-3/16	3/4	DT0420112			
4	2	800	2-3/16	1-3/16	1/2		DT0422808*	DT0422908	
5	2	1200	2-3/16	1-3/16	3/4	DT0520112			
5	2	1000	2-3/16	1-3/16	1/2		DT0522808*	DT0522908	
6	2	1400	2-3/16	1-3/16	3/4	DT0620112			
6	2	1200	2-3/16	1-3/16	1/2		DT0622808*	DT0622908	
8	2	1600	2-3/16	1-3/16	3/4	DT0820112			
8	2	1400	2-3/16	1-3/16	1/2		DT0822808*	DT0822908	

*Requires (2) top hats to achieve 1/2" ID; order (2) of part number 41774 for each wheel ordered.

WHEEL OPTIONS

- Note: Select bearings featured are recommended for standard applications. For special applications or alternate bearings consult factory. See bearing information on page 13.
- For customization & special application options, please consult factory.
- For stainless steel roller bearing specify **ZB03**.



NG Economical Maxim® Glass Filled Nylon



Albion's Maxim® wheel delivers maximum performance and an economical solution for your most demanding caster applications. With a focus on ergonomics, this advanced wheel starts rolling, keeps rolling and swivels with ease! The innovative nylon and fiberglass construction stands up to solvents, extreme temperatures and high load capacities. Maxim wheels won't absorb moisture!

FEATURES

- **Wheel face:** Slight crown
- **Finish:** Black
- **Temperature Range:** -40° to +250°F
- **Hardness:** 85 Shore D ±5

WHEEL OPTIONS

- Note: Select bearings featured are recommended for standard applications. For special applications or alternate bearings consult factory. See bearing information on page 13
- For customization & special application options, please consult factory

Wheel Diameter (Inches)	Tread Width (Inches)	Capacity (Lbs) (Based for manual operation)	Hub Length (Inches)	Bore ID (Inches)	Bearing ID (Inches)	Approx. Wt. (Lbs)	Wheel Number	Wheel Number Pedestal Precision Ball (29)*
3-1/4	2	700	2-3/16	1-3/16	3/4	1	NG0320112	
3-1/4	2	700	2-3/16	1-3/16	1/2	1		NG0322908
4	2	800	2-3/16	1-3/16	3/4	1	NG0420112	
4	2	800	2-3/16	1-3/16	1/2	1		NG0422908
5	2	1000	2-3/16	1-3/16	3/4	1	NG0520112	
5	2	1000	2-3/16	1-3/16	1/2	1		NG0522908
6	2	1200	2-3/16	1-3/16	3/4	1-1/8	NG0620112	
6	2	1200	2-3/16	1-3/16	1/2	1-1/8		NG0622908
8	2	1400	2-3/16	1-3/16	3/4	1-3/8	NG0820112	
8	2	1400	2-3/16	1-3/16	1/2	1-3/8		NG0822908
10	2-1/2	1500	2-3/4	1-3/16	3/4		NG1040712	

* Hub length of pedestal precision bearing (29) models is 2-7/16".

NW Premium Quality Economical White Nylon



Economical, Strong, Clean.
Excellent for clean rooms!

FEATURES

- **Wheel face:** Moderate crown
- Composed of injection molded white nylon
- Maximum performance, economical solution for your most demanding caster applications
- Excellent ergonomics ... wheel starts rolling, keeps rolling and swivels with ease
- **Temperature Range:** -20°F to 250°F
- **Hardness:** 85 Shore D ±5

WHEEL OPTIONS

- Note: Select bearings featured are recommended for standard applications. For special applications or alternate bearings consult factory. See bearing information on page 13
- For customization & special application options, please consult factory

Wheel Diameter (Inches)	Tread Width (Inches)	Capacity (Lbs) (Based for manual operation)	Hub Length (Inches)	Bore ID (Inches)	Bearing ID (Inches)	Approx. Weight (Lbs)	Bearing	Wheel Number
5	2	600	2-3/16	1-3/16	1-3/16	1	Plain Bore	NW0520019
5	2	600	2-3/16	1-3/16	3/4	1	Roller	NW0520112
5	2	600	2-3/16	1-3/16	1/2	1	Pedestal Precision Ball	NW0522908
5	2	600	2-3/16	1-3/16	3/4	1	Delrin	NW0525112
6	2	900	2-3/16	1-3/16	1-3/16	1-1/4	Plain Bore	NW0620019
6	2	900	2-3/16	1-3/16	3/4	1-1/4	Roller	NW0620112
6	2	900	2-3/16	1-3/16	1/2	1-1/4	Pedestal Precision Ball	NW0622908
6	2	900	2-3/16	1-3/16	3/4	1-1/4	Delrin	NW0625112
8	2	1100	2-3/16	1-3/16	1-3/16	2	Plain Bore	NW0820019
8	2	1100	2-3/16	1-3/16	3/4	2	Roller Bearing	NW0820112
8	2	1100	2-3/16	1-3/16	1/2	2	Pedestal Precision Ball	NW0822908
8	2	1100	2-3/16	1-3/16	3/4	2	Delrin	NW0825112



NX

 Premium Quality

 Maintenance Free

 Ergonomic

Trionix™ High Impact Polymer



These unique high impact polymer wheels deliver superior rollability, capacity and slide resistance. Trionix™ features unique polymers that resist corrosion and most chemicals. Wheels are machined and straight sided.

FEATURES

- **Wheel face:** Slight crown
- **Finish:** Black
- **Temperature Range:** -30°F to +220°F
- **Hardness:** 78-82 Shore D

WHEEL OPTIONS

- Note: Select bearings featured are recommended for standard applications. For special applications or alternate bearings consult factory. See bearing information on page 13
- For customization & special application options, please consult factory

		Wheel Diameter (Inches)	Tread Width (Inches)	Capacity (Lbs) (Rated for normal operation)	Hub Length (Inches)	Bore ID (Inches)	Bearing ID (Inches)	Approx. Wt. (LBS)	Wheel Number Precision Ball (28)
Trionix High Impact Polymer (NX)									
4	2	2160	2-7/16	2	1/2	4			NX0422808
5	2	2160	2-7/16	2	1/2	5			NX0522808
6	2	2160	2-7/16	2	1/2	6			NX0622808
6	2-1/2	7200	3	2	3/4	6-1/2			NX0642812
6	3	7200	3-1/2	2	3/4	6-1/2			NX0652812
8	2	2160	2-7/16	2	1/2	8			NX0822808
8	2-1/2	7200	3	2	3/4	9			NX0842812
8	3	7200	3-1/2	2	3/4	9			NX0852812
10	2-1/2	7200	3	2	3/4	10			NX1042812
10	3	7200	3-1/2	2	3/4	10			NX1052812

Note: For 6", 8" and 10" diameter wheels, use ZY1216003 top hats to increase all 2-1/2" wide wheels to 3-1/2" hub length.

NV

 Premium Quality

 Maintenance Free

Trionix™ High Impact Polymer V-Groove



Like the NX wheels, these unique high impact polymer wheels deliver superior rollability, capacity and slide resistance. Trionix™ features unique polymers that resist corrosion and most chemicals. Wheels are machined with V-groove.

FEATURES

- **Wheel face:** Slight crown
- **Finish:** Black
- **Temperature Range:** -30°F to +220°F
- **Hardness:** 78-82 Shore D

WHEEL OPTIONS

- Note: Select bearings featured are recommended for standard applications. For special applications or alternate bearings consult factory. See bearing information on page 13
- For customization & special application options, please consult factory

		Wheel Diameter (Inches)	Tread Width (Inches)	Capacity (Lbs) (Rated for normal operation)	Hub Length (Inches)	Bore ID (Inches)	Groove Width "A" (Inches)	Groove Depth "B" (Inches)	Wheel Number Precision Ball (28)
Trionix V-Groove High Impact Polymer (NV)									
4	2	2160	2-7/16	1/2	.88	.44			NV0422808
5	2	2160	2-7/16	1/2	.88	.44			NV0522808
6	2	2160	2-7/16	1/2	.88	.44			NV0622808
8	2	2160	2-7/16	1/2	.88	.44			NV0622808

*Spanner held in place with snap rings to prevent loss of top hat.

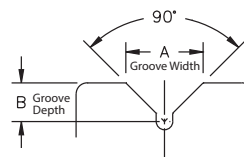

Letters match to chart descriptions

TH/TS



Economical

Straight Sided Phenolic



TH/TS wheels are molded of heavy macerated or chopped cotton denim, impregnated with phenolic resin and formed in close fitting molds under high pressure and temperature. They are non-marking and excellent load carriers.

FEATURES

- **Wheel face:** Moderate crown
- **Finish:** Black
- **Temperature Range:** -65°F to +250°F (+300°F intermittent)
- **Hardness:** Rockwell 102 E

WHEEL OPTIONS

- Note: Select bearings featured are recommended for standard applications. For special applications or alternate bearings consult factory. See bearing information on page 13
- For customization & special application options, please consult factory

	Wheel Diameter (Inches)	Tread Width (Inches)	Capacity (Lbs) (Based on manual operation)	Hub Length (Inches)	Bore ID (Inches)	Bearing ID (Inches)	Approx. Wt. (Lbs)	Wheel Number Roller Bearing (01)
Straight Sided Phenolic (TH, TS)								
4	1-1/2	500	1-27/32	1-1/16	3/4	3/4		TS0410112
4	1-7/8	800	2-13/32	1-3/16	3/4	1		TS0420112
4	2	1000	2-3/16	1-3/16	1/2	1-3/4		TH0420108
4	2	1000	2-3/16	1-3/16	5/8	1-3/4		TH0420110
4	2	1000	2-3/16	1-3/16	3/4	1-3/4		TH0420112~
5	1-1/2	500	1-27/32	1-1/16	3/4	1-1/4		TS0510112~
5	1-7/8	1000	2-13/32	1-3/16	3/4	1-1/2		TS0520112
5	2	1200	2-3/16	1-3/16	1/2	2-1/4		TH0520108
5	2	1200	2-3/16	1-3/16	5/8	2-1/4		TH0520110
5	2	1200	2-3/16	1-3/16	3/4	2-1/4		TH0520112~
6	1-1/2	500	1-27/32	1-3/16	3/4	1-1/4		TS0610112
6	1-7/8	1200	2-13/32	1-3/16	3/4	1-3/4		TS0620112
6	2	1500	2-3/16	1-3/16	1/2	3		TH0620108
6	2	1500	2-3/16	1-3/16	5/8	3		TH0620110
6	2	1500	2-3/16	1-3/16	3/4	3		TH0620112~
8	1-7/8	1400	2-13/32	1-3/16	3/4	4		TS0820112

~ Wheels are complete with spanner bushing and nylon sealed retaining/thrust washer.

TM



Economical

Phenolic



TM wheels are molded of heavy macerated or chopped cotton denim, impregnated with phenolic resin and formed in close fitting molds under high pressure and temperature. They are non-marking and excellent load carriers.

FEATURES

- **Wheel face:** Moderate crown
- **Finish:** Black
- **Temperature Range:** -65°F to +250°F (+300°F intermittent)
- **Hardness:** Rockwell 102 E

WHEEL OPTIONS

- Note: Select bearings featured are recommended for standard applications. For special applications or alternate bearings consult factory. See bearing information on page 13
- For customization & special application options, please consult factory

	Wheel Diameter (Inches)	Tread Width (Inches)	Capacity (Lbs) (Based on manual operation)	Hub Length (Inches)	Bore ID (Inches)	Bearing ID (Inches)	Approx. Wt. (Lbs)	Wheel Number Roller Bearing (01)	Wheel Number Tapered Roller (09)
Phenolic (TM)									
3	1-1/4	400	1-3/8	1-1/16	1/2	1/2		TM0300108	
3-1/4	1-1/2	600	1-5/8	1-3/16	1/2	3/4		TM0310108	
3-1/4	1-1/2	600	1-5/8	1-3/16	5/8	3/4		TM0310110	
3-1/4	1-1/2 [^]	600	1-5/8	1-3/16	3/4	3/4		TM0310112~	
3-1/4	2	700	2-3/16	1-3/16	1/2	1-1/4		TM0320108	
3-1/4	2	700	2-3/16	1-3/16	5/8	1-1/4		TM0320110	
3-1/4	2	700	2-3/16	1-3/16	3/4	1-1/4		TM0320112~	
3-1/2	1-1/4	400	1-3/8	1-1/16	1/2	3/4		TM03X0108	
4	1-1/4	400	1-3/8	1-1/16	1/2	3/4		TM0400108	
4	1-1/2	600	1-5/8	1-3/16	1/2	1		TM0410108	
4	1-1/2	600	1-5/8	1-3/16	5/8	1		TM0410110	
4	1-1/2 [^]	600	1-5/8	1-3/16	3/4	1		TM0410112~	
4	2	800	2-3/16	1-3/16	1/2	1-1/2		TM0420108	
4	2	800	2-3/16	1-3/16	5/8	1-1/2		TM0420110	
4	2	800	2-3/16	1-3/16	3/4	1-1/2		TM0420112~	
5	1-1/4	400	1-3/8	1-1/16	1/2	1-1/4		TM0500108	
5	1-1/2	600	1-5/8	1-3/16	1/2	1-1/2		TM0510108	
5	1-1/2	600	1-5/8	1-3/16	5/8	1-1/2		TM0510110	
5	1-1/2 [^]	600	1-5/8	1-3/16	3/4	1-1/2		TM0510112~	
5	2	1000	2-3/16	1-3/16	1/2	1-3/4		TM0520108	
5	2	1000	2-3/16	1-3/16	5/8	1-3/4		TM0520110	
5	2	1000	2-3/16	1-3/16	3/4	1-3/4		TM0520112~	
6	1-1/2	800	1-5/8	1-3/16	1/2	1-1/2		TM0610108	
6	1-1/2	800	1-5/8	1-3/16	5/8	1-1/2		TM0610110	
6	1-1/2 [^]	800	1-5/8	1-3/16	3/4	1-1/2		TM0610112~	
6	2	1200	2-3/16	1-3/16	1/2	2-1/2		TM0620108	
6	2	1200	2-3/16	1-3/16	5/8	2-1/2		TM0620110	

~ Wheels are complete with spanner bushing and nylon sealed retaining/thrust washer.

[^] 2 7/16" spanner and spacers included.

**Specially machined wheel built from 2 modified 3" tread width wheels.

PHENOLIC WHEELS • UP TO 1500



Continued from previous page.

Phenolic



See previous page for TM description and product details.

TR Heat Resistant Phenolic



Similar to TM wheels, but the temperature range increases to up to +475°F continuous use or +525°F intermittent use for TR wheels. Color is reddish green. See TM wheel for features and options. To order TR wheels, change TM wheel number to **TR**. Example: **TR1040116**. Capacities are reduced – consult factory.

TL Laminated Phenolic



Consult factory for models and options

TL wheels feature a laminated tread that is highly resistant to chipping or fraying. Wheels are molded of heavy macerated or chopped cotton denim, impregnated with phenolic resin and formed in close fitting molds under high pressure and temperature. They are non-marking and excellent load carriers. Color is brown with black core. See TM wheel for features and options. To order TL wheels, change **TM** in wheel number to **TL**. Example: **TL1040116**.

Phenolic (TM)							Wheel Number Roller (01, 05, 07)	Wheel Number Tapered Roller (09)
Wheel Diameter (Inches)	Tread Width (Inches)	Capacity (Lbs) (Rated for manual operation)	Hub Length (Inches)	Bore ID (Inches)	Bearing ID (Inches)	Approx. Wt. (Lbs)		
6	2	1200	2-3/16	1-3/16	3/4	2-1/2	TM0620112~	
6	2-1/2	1600	3-1/4	1-15/16	1	4-1/2	TM0640116	
6	2-1/2	1600	3-1/4	1-15/16	1-1/4	4-1/2	TM0640120	
6	2-1/2	1600	2-3/4	1-15/16	1	4-1/4	TM0640516	
6	2-1/2	1600	2-3/4	1-3/16	3/4	3-1/2	TM0640712	
6	2-1/2	1600	3-1/2	1-15/16	3/4	4-1/4		TM0640912
6	3	2000	3-1/4	1-3/16	1	5	TM0650116	
6	3	2000	3-1/4	1-3/16	1-1/4	5	TM0650120	
6	3	2000	3-1/2	1-3/16	3/4	4-3/4		TM0650912
6	3	2000	3-1/2	1-3/16	1	4-3/4		TM0650916
6	3	2000	3-1/2	1-1/16	1-1/4	4-3/4		TM0650920
7	3	2200	3-1/4	1-15/16	1	6-1/2	TM0750116	
7	3	2200	3-1/4	1-15/16	1-1/4	6-1/2	TM0750120	
7	3	2200	3-1/2	1-15/16	3/4	6-1/4		TM0750912
7	3	2200	3-1/2	2	1	6-1/4		TM0750916
7	3	2200	3-1/2	2-11/32	1-1/4	6-1/4		TM0750920
8	2	1400	2-3/16	1-3/16	5/8	4	TM0820110	
8	2	1400	2-3/16	1-3/16	3/4	4	TM0820112~	
8	2-1/2	2000	3-1/4	1-15/16	1	6-1/4	TM0840116	
8	2-1/2	2000	3-1/4	1-15/16	1-1/4	6-1/4	TM0840120	
8	2-1/2	1800	2-3/4	1-15/16	1	5-3/4	TM0840516	
8	2-1/2	1600	2-3/4	1-3/16	3/4	5-1/4	TM0840712	
8	2-1/2	2000	3-1/2	1-15/16	3/4	6		TM0840912
8	2-1/2	2000	3-1/2	2	1	6		TM0840916
8	3	2500	3-1/4	1-15/16	1	7-1/4	TM0850116	
8	3	2500	3-1/4	1-15/16	1-1/4	7-1/4	TM0850120	
8	3	2500	3-1/2	1-15/16	3/4	7		TM0850912
8	3	2500	3-1/2	2	1	7		TM0850916
8	3	2500	3-1/2	2-11/32	1-1/4	7		TM0850920
8	6**	5000	6-1/2	2-11/32	1-1/4	15-1/2		TM0890920
10	2-1/2	2500	3-1/4	1-15/16	1	7-3/4	TM1040116	
10	2-1/2	2500	3-1/4	1-15/16	1-1/4	7-3/4	TM1040120	
10	2-1/2	2500	2-3/4	1-15/16	1	7-1/2	TM1040516	
10	2-1/2	2500	2-3/4	1-3/16	3/4	7	TM1040712	
10	3	2900	3-1/4	1-15/16	1	9-3/4	TM1050116	
10	3	2900	3-1/4	1-15/16	1-1/4	9-3/4	TM1050120	
10	3	2900	3-1/2	1-15/16	3/4	9-1/2		TM1050912
10	3	2900	3-1/2	2	1	9-1/2		TM1050916
10	3	2900	3-1/2	2-11/32	1-1/4	9-1/2		TM1050920
10	6**	5800	6-1/2	2-11/32	1-1/4	20-1/2		TM1090920
12	2-1/2	3000	3-1/4	1-15/16	1	11-3/4	TM1240116	
12	2-1/2	3000	3-1/4	1-15/16	1-1/4	11-3/4	TM1240120	
12	2-1/2	1800	2-3/4	1-15/16	1	11-1/4	TM1240516	
12	3	3500	3-1/4	1-15/16	1	12-3/4	TM1250116	
12	3	3500	3-1/4	1-15/16	1-1/4	12-3/4	TM1250120	
12	3	3500	3-1/2	1-15/16	3/4	12-1/2		TM1250912
12	3	3500	3-1/2	2	1	12-1/2		TM1250916
12	3	3500	3-1/2	2-11/32	1-1/4	12-1/2		TM1250920
12	3-1/2	4000	4-1/4	2-7/16	1-1/4	23-1/2	TM1260120	
12	3-1/2	4000	4-1/4	2-7/16	1-1/2	23-1/2	TM1260124	
12	3-1/2	4000	4-1/2	2-7/16	1	23		TM1260916
12	3-1/2	4000	4-1/2	2-7/16	1-1/4	23		TM1260920
12	4	8000	4-1/2	2-11/32	1-1/4	26-1/4		TM1270920
16	3	4000	4-1/4	2-7/16	1-1/4	25	TM1650120	
16	3	4000	4-1/4	2-7/16	1-1/2	25	TM1650124	
16	3	4000	4-1/2	2-7/16	1-1/4	25-3/4		TM1650920
16	4	8000	5-1/4	2-7/16	1-1/4	35-3/4	TM1670120	
16	4	8000	5-1/4	2-7/16	1-1/2	35-3/4	TM1670124	
16	4	8000	5-1/2	2-7/16	1-1/4	34-1/4		TM1670920
18	3	3500	3-1/4	1-15/16	1	23-3/4	TM1850116	
18	3	3500	3-1/4	1-15/16	1-1/4	23-3/4	TM1850120	

~ Wheels are complete with spanner bushing and nylon sealed retaining/thrust washer.

^ 2⁷/₁₆" spanner and spacers included.

**Specially machined wheel built from 2 modified 3" tread width wheels.

PB Economical Polypropylene



This wheel is an injection molded blend of thermo-plastic polymers which resist absorption and are resistant to most chemicals and solvents. Capacity ratings are comparable to hard rubber wheels with the added advantage of being lighter in weight and having greater impact resistance.

FEATURES

- **Wheel face:** Moderate crown
- **Finish:** Black
- **Temperature Range:** -20°F to +180°F
- **Hardness:** 65 Shore D

WHEEL OPTIONS

- Note: Select bearings featured are recommended for standard applications. For special applications or alternate bearings consult factory. See bearing information on page 13
- For customization & special application options, please consult factory

PW Economical White Polypropylene



Same options as PB



Heat Resistant

RW RETORT Polypropylene



Designed to withstand the rigors of high temperature, RW wheels are perfect for cooker racks and retort carts. The oversized bore ID ensures smooth movement, even if wheels experience heat expansion.

FEATURES

- **Wheel Face:** Moderate crown
- **Finish:** White
- **Temperature Range:** -20°F degrees up to +290°F
- **Hardness:** 75 Shore D
- Same options as PB

Polypropylene (PB)										Wheel Number Delrin Bearing (51)	Wheel Number Plain Bore (41)
Wheel Diameter (Inches)	Tread Width (Inches)	Capacity (Lbs) (Based for manual operation)	Hub Length (Inches)	Bore ID (Inches)	Bearing ID (Inches)	Approx. Wt. (Lbs)	Wheel Number Roller Bearing (01)				
3	1-3/8	250	1-1/2	1-5/16	1/2	1/2				PB0305108	
3	1-1/4	250	1-1/2	1/2	1/2	1/2					PB0304108
3-1/2	1-3/8	275	1-1/2	1-5/16	1/2	1/2				PB03X5108	
4	1-1/4	300	1-1/2	1/2	1/2	1/2					PB0404108
4	1-3/8	300	1-1/2	1-5/16	1/2	1/2				PB0405108	
4	1-1/2 [^]	400	1-5/8	1-3/16	1/2	3/4			PB0410112~		
4	2	450	2-3/16	3/4	3/4	1/2			PB0420112~		PB0424112
4	2	450	2-3/16	1-3/16	3/4	1					
5	1-1/4	450	1-1/2	1/2	1/2	1/2					PB0504108
5	1-1/4	450	1-1/2	1-5/16	1/2	1/2					PB0505108
5	1-1/2 [^]	450	1-5/8	1-3/16	3/4	1			PB0510112~		
5	2	550	2-3/16	3/4	3/4	3/4			PB0520112~		PB0524112
5	2	650	2-3/16	1-3/16	3/4	1-1/4					
6	1-1/2 [^]	550	1-5/8	1-3/16	3/4	1			PB0610112~		
6	2	650	2-3/16	3/4	3/4	1					PB0624112
6	2	750	2-3/16	1-3/16	3/4	1-1/2			PB0620112~		
8	2	850	2-3/16	3/4	3/4	1-1/4					PB0824112
8	2	1000	2-3/16	1-3/16	3/4	1-3/4			PB0820112~		

~ Wheels are complete with spanner bushing & nylon retaining thrust washers.

[^] 27/16" spanner and spacers included.

White Polypropylene (PW)										Wheel Number Plain Bore (41)	Wheel Number Delrin Bearing (51)*
Wheel Diameter (Inches)	Tread Width (Inches)	Capacity (Lbs) (Based for manual operation)	Hub Length (Inches)	Bore ID (Inches)	Bearing ID (Inches)	Approx. Wt. (Lbs)	Wheel Number Roller Bearing (01)				
3	1-1/4	250	1-7/16	1/2	1/2	1/2				PW0304108	
3-1/2	1-1/4	275	1-7/16	1/2	1/2	1/2				PW03X4108	
4	1-1/4	300	1-7/16	1/2	1/2	1/2				PW0404108	
4	1-1/2	400	1-5/8	3/4	3/4	1/2				PW0414112	
4	2	450	2-3/16	3/4	3/4	3/4				PW0424112	
4	2	450	2-3/16	1/2	1/2	3/4				PW0424108	
5	1-1/4	450	1-7/16	1/2	1/2	1/2				PW0504108	
5	1-1/2	450	1-5/8	3/4	3/4	1/2				PW0514112	
5	2	550	2-3/16	3/4	3/4	3/4				PW0524112	
5	2	650	2-3/16	1/2	1/2	3/4				PW0524108	
5	2	650	2-3/8	1/2	3/4	3/4					PW0525112
6	1-1/2	550	1-5/8	3/4	3/4	3/4				PW0614112	
6	2	650	2-3/16	3/4	3/4	3/4				PW0624112	
6	2	750	2-3/16	1/2	1/2	3/4				PW0624108	
6	2	750	2-3/8	1/2	3/4	3/4					PW0625112

* Hub length of Delrin bearing (51) models is 2-9/16".

RETORT Polypropylene (RW)										Wheel Number Roller Bearing (01)	Wheel Number Plain Bore (41)
Wheel Diameter (Inches)	Tread Width (Inches)	Capacity (Lbs) (Based for manual operation)	Hub Length (Inches)	Bore ID (Inches)	Bearing ID (Inches)	Approx. Wt. (Lbs)	Wheel Number Roller Bearing (01)				
3	1-3/8	300	1-1/2	1/2	1/2	1/4					RW0304108
3-1/2	1-3/8	300	1-1/2	1/2	1/2	1/4					RW03X4108
4	1-3/8	300	1-1/2	1/2	1/2	3/4					RW0404108
4	1-1/2 [^]	375	1-5/8	1-3/16	3/4	1			RW0410112		
4	2	500	2-3/16	1-3/16	3/4	1			RW0420112		
5	1-3/8	440	1-1/2	1/2	1/2	1					RW0504108
5	1-1/2 [^]	540	1-5/8	1-3/16	3/4	1			RW0510112		
5	2	650	2-3/16	1-3/16	3/4	1/2			RW0520112		
6	1-1/2 [^]	600	1-5/8	1-3/16	3/4	1/2			RW0610112		
6	2	700	2-3/16	1-3/16	3/4	2			RW0620112		
8	1-1/2 [^]	750	1-5/8	1-3/16	3/4	2			RW0810112		
8	2	900	2-3/16	1-3/16	3/4	2-1/2			RW0820112		

[^] 27/16" spanner and spacers included.