

# Ball Metal Tread



## Features

- Industry leading selection and overall value
- Fast deliveries for any order quantity
- Self-lubricating acetyl resin bearing
- No exposed axle

## Applications

- Store Fixtures
- Furniture
- Office Equipment
- Medical Equipment

## Options

- **Brake** 2-1/2" diameter models.
- **Tred-Gard®** cover protects tread from scratches during manufacturing and shipping. To order add [-T] to end of Part Number. Available for 2" and 2-1/2" models. For field installable Tred-Gards order **001391** for 2" and **001550** for 2-1/2" models.



Wheel Diameter (Inches)	Mounting Height (Inches)	Swivel Radius (Inches)	Finish Type	Dynamic Load (Pounds)	Base Model # (Add fastening code)	Brake Model # (Add fastening code)	Fastening Selection*
<b>1-1/2" Starlet</b>	Thread/Plate: 1-13/16" Grip Ring/Grip Neck: 1-5/8"	1-3/16"	Bright Brass	40	PST15___BB		<b>Threaded: 525</b> <b>Grip Neck: 302</b> <b>Plate: 1R</b>
			Bright Chrome	40	PST15___BC		
			Windsor Antique	40	PST15___WA		
<b>2" Satellite</b>	Thread: 2-5/16" Grip Ring/Grip Neck: 2-3/16" Plate: 2-1/2"	1-1/2"	Bright Brass	75	PSE20___BB		<b>Threaded: 507, 525, 605, 637, 639, 828</b> <b>Grip Neck: 302</b> <b>Grip Ring: 211, 222, 223</b> <b>Plate: 101, 113</b>
			Bright Chrome	75	PSE20___BC		
			Satin Chrome	75	PSE20___SC		
			Windsor Antique	75	PSE20___WA		
<b>2-1/2" Planet</b>	Thread: 2-13/16" Grip Ring/Grip Neck: 2-11/16" Plate: 3"	1-7/8" Brake: 2-5/16"	Bright Brass	100	PPL25___BB	PPL25___BB-B	<b>Threaded: 512, 525, 526, 545, 605, 637, 639</b> <b>Grip Neck: 302</b> <b>Grip Ring: 211, 222, 223</b> <b>Plate: 101, 113</b>
			Bright Chrome	100	PPL25___BC	PPL25___BC-B	
			Satin Chrome	100	PPL25___SC	PPL25___SC-B	
			Windsor Antique	100	PPL25___WA	PPL25___WA-B	

\*To order, include blue fastener code in Base Model Number. Example: PST150525BB

## Threaded Stem

828 — 525 — 545 — 507 — 526 — 512 — 639 — 637 — 605

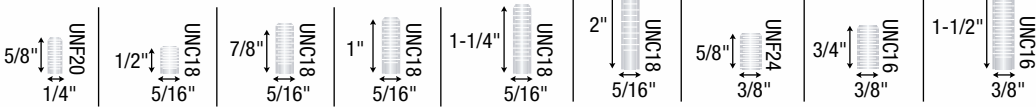

## Grip Neck Grip Ring

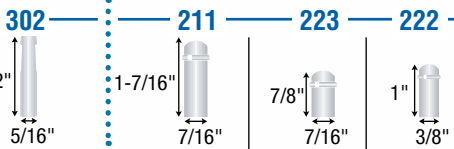

## Top Plate

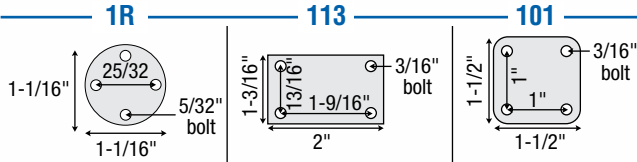

Bright Chrome



Bright Brass



Windsor Antique



Satin Chrome



Note: Unfinished models available

## Socket Options

Shepherd has many solutions to help you mount your casters to your equipment quickly and easily. See pages 56-57 for more information.



# Ball Soft Tread

## Features

- Industry leading selection and overall value
- Fast deliveries for any order quantity
- Self-lubricating acetyl resin bearing
- No exposed axle
- Rubber tread; Urethane for 1-9/16" diameter models

## Applications

- Store Fixtures
- Furniture
- Office Equipment
- Medical Equipment

## Options

- **Brake:** 3" diameter models only.
- Unfinished available
- **Locking Pin:** Available on 3" non-brake unfinished models. To order change "PSN" to "PNL" in Model Number.



Wheel Diameter (Inches)	Mounting Height (Inches)	Swivel Radius (Inches)	Finish Type	Dynamic Load (Pounds)	Base Model # (Add fastening code)	Brake Model # (Add fastening code)	Fastening Selection*
<b>1-9/16" Cosmo</b>	Thread/Plate: 1-13/16" Grip Ring/Grip Neck: 1-11/16"	1-1/16"	Bright Brass	40	PCM40___BB		<b>Threaded: 525</b> <b>Grip Neck: 302</b> <b>Plate: 1R</b>
<b>2-1/4" Nova</b>	Threaded: 2-7/16" Grip Ring/Grip Neck: 2-5/16" Plate: 2-5/8"	1-9/16"	Bright Brass	75	PNA22___BB		<b>Threaded: 507, 525, 605, 637, 639, 828</b> <b>Grip Neck: 302</b> <b>Grip Ring: 211, 222, 223</b> <b>Plate: 101, 113</b>
			Bright Chrome	75	PNA22___BC		
			Satin Chrome	75	PNA22___SC		
			Windsor Antique	75	PNA22___WA		
			Unfinished	75	PNA22___UF		
<b>3" Saturn</b>	Thread: 3" Grip Ring/Grip Neck: 2-7/8" Plate: 3-3/16"	2-1/16" Brake: 2-5/16"	Bright Brass	100	PSN30___BB	PSN30___BB-B	<b>Threaded: 512, 525, 526, 545, 605, 637, 639</b> <b>Grip Neck: 302</b> <b>Grip Ring: 211, 222, 223</b> <b>Plate: 101, 113</b>
			Bright Chrome	100	PSN30___BC	PSN30___BC-B	
			Satin Chrome	100	PSN30___SC	PSN30___SC-B	
			Windsor Antique	100	PSN30___WA	PSN30___WA-B	
			Unfinished	100	PSN30___UF	PSN30___UF-B	



\*To order, include blue fastener code in Base Model Number. Example: PCM40**525**BB

## Threaded Stem

828 — 525 — 545 — 507 — 526 — 512 — 639 — 637 — 605

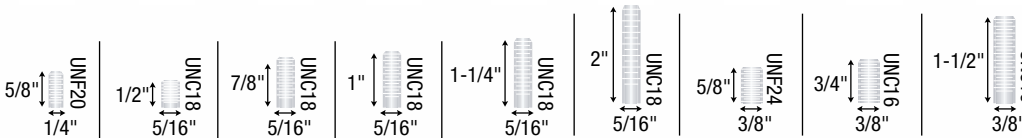

## Grip Neck Grip Ring

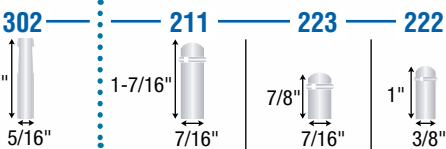

## Top Plate

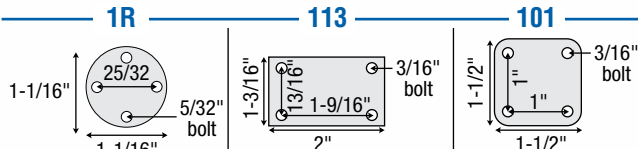

## Socket Options

Shepherd has many solutions to help you mount your casters to your equipment quickly and easily. See pages 56-57 for more information.



Note: Unfinished models available

# Baron



## Features

- Double ball bearing raceways
- Octagon washer on threaded stem for easy installation
- 2" model is heat treated

## Applications

- Store Fixtures
- Furniture
- Office Equipment
- Medical Equipment

## Options

- RoHS compliant zinc finish available by special order; please consult factory for details.

## Wheel Selection



1-5/8" Spherical Soft Rubber    2" Spherical Polyolefin

Wheel Diameter (Inches)	Mounting Height (Inches)	Swivel Radius (Inches)	Tread Material	Finish Type	Dynamic Load (Pounds)	Base Model # (Add fastening code)	Fastening Selection*
1-5/8"	2-5/16"	1-3/4"	Spherical Soft Rubber	Metalized Brass	70	PBH16____MB-3RD	<b>Threaded: 532, 507</b> <b>Grip Neck: 302</b>
				Windsor Antique	70	PBH16____WA-3RD	<b>Grip Ring: 223, 211</b> <b>Plate: 113</b>
2"	2-5/8"	2-1/4"	Spherical Polyolefin	Bright Chrome	80	PBH20____BC-3ED	<b>Threaded: 532, 507, 634, 605</b>
				Metalized Brass	80	PBH20____MB-3ED	<b>Grip Neck: 302</b>
				Windsor Antique	80	PBH20____WA-3ED	<b>Grip Ring: 222, 223, 211</b> <b>Plate: 113</b>

\*To order, include blue fastener code in Base Model Number. Example: PBH16507MB-3RD

## Threaded

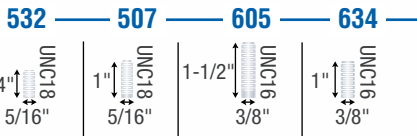

## Grip Neck

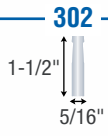

## Grip Ring

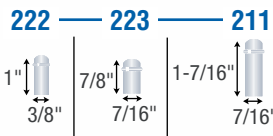

## Top Plate

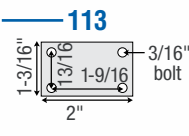

## Finish Options



Metalized Brass



Windsor Antique



Bright Chrome

## Socket Options

Shepherd has many solutions to help you mount your casters to your equipment quickly and easily. See pages 56-57 for more information.



Connects casters to wood



Connects casters to round tubes



Connect casters to PVC pipe legs



Weldable caster mount



Connects casters to square tubes



Corner brackets